

TOTAL SOLUTIONS FOR MOVEMENT

**PASSENGER
ELEVATOR**



**FRANKSON[®]
GROUP**

Elevator & Escalator

- www.franksonlevator.com
- www.frankson.in
- www.franksongroup.com

FRANKSONGROUP
Safety, Comfort, Technology

FRANKSON[®]
GROUP
Elevator & Escalator



About Us :

In the Year 1984 we started a Company named " KINGFISHER INDIA ELEVATOR ". Initially ,We were supplying all types of Elevator in some cities of India. In the Year 2001, we made an Elevator Factory in a 2 Storied Building covering an area of 21280 Sq. Feet near Kolkata.

With the intension of making our Company with a Brand Name We started FRANKSON BRAND NAME with Registered Trademark, CE, ISO 9001-2008, ISO-18001-2007 & other Certifications in the Year 2008. Then we started Joint Venture in Technology Replacement with World Famous Branded Elevator Companies of China, Korea & European Countries.

FRANKSON GROUP is a growing Company. To provide better & prompt service & customer satisfaction , we started making a World Class Category Elevator Escalator & Travelator factory at Baduria covering an area of 57580 Sq Feet with four storied Decorative Office Complex Building. Now, We are importing 60% of the Materials from China , Korea , Europe & the rest 40% Materials are manufacturing in our own factory & then the Materials are being tested & assembled by our Qualified & Competent Engineer & then these Materials are installed in our Project site.

For Highrise Buildings , we are importing complete Lift Material from our associate Companies from China , Korea & European Branded Companies. You can compare our Lift Material with any Internationally reputed Branded Companies & this is our challenge. We have four types of Shipments & these are 1) Indian Shipment, 2) Chinese Shipment , 3) Korean Shipment, 4) European Shipment. As per the Customer's Project budget, we provide the Shipment.

Frankson Group (An ISO 9001-2008, ISO 18001-2007 & CE Certified Company) is a well known name in industry engaged in manufacturing, exporting, supplying and distributing of all types of high quality Elevators Escalator & Travelator. Our range of products includes Passenger lifts both with machine room and MRL, Home Lifts, Glass Panoramic Lifts, Hospital Lifts, Freight Lifts, Automobile Lift, Goods Lift, Hydraulic Lift, Escalators & Travelators. We are working on all cities of India & Nepal, Bhutan Bangladesh, Srilanka, Cambodia. Our Planning is to work on other Countries over the World. We have built a well developed infrastructure that is installed with latest machines and other related facilities that help us in fabricating the wide range of Lifts.



India Eastern Zone Second Factory
(38520 Sq. Ft. Area)



India Estran Zone Third Factory Having World Class
Category Under Construction
(93234 Sq. Ft. Area)



India Eastern Zone First Factory
(21280 Sq. Ft. Area)

Autodoor Elevator

Whether you are planning for a high rise, high performance, high speed or simply high specification solution, we offer a range of elevators and innovations that were developed with these needs in mind.



Elevators are the main transportation arteries in the modern building and are vital in determining a building's economic success.

We manufacture all types of passenger lifts of different capacity and speed. Our latest passenger lifts comprises of V3F Close & open loop microprocessor Controller with sophisticated steel car & latest electronic components that has low power consumption and are also maintenance free. We offer different types of cabins using material such as M.S., S.S., Glass. We provide latest version of Auto doors for cabin and landings which are specially designed in Germany with superior technical precision.



www.franksonellevator.com

MR Type Passenger Elevator



Infrared Light Curtain Protection



Top grade door machine system

Fully computerized VVVF closed-loop control mode fulfills the smooth operation. It needs no position switch. Internal self-tuning function records various floor door widths by memory. It ensures the accurate and proper door-opening.



Hoistway Machine Room Plan For Auto Door

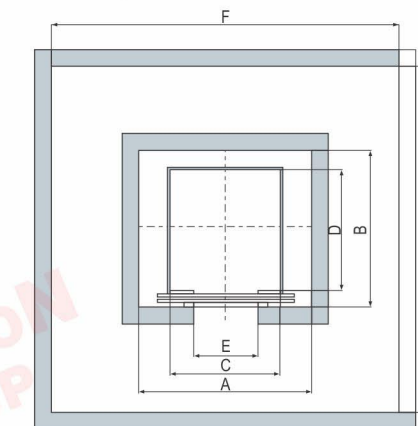

Hoistway Elevation Drawing

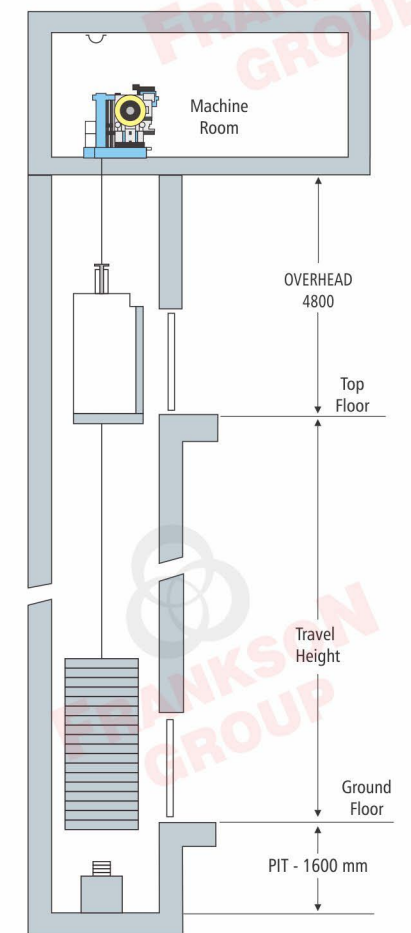

Hoist Way Machine Room Size Passenger Lift With Auto Doors

LOAD		LIFT WELL		CAR INSIDE		ENTRANCE	MACHINE ROOM			SPEED UP TO 1 m/s.	
PERSON	WEIGHT	WIDTH	DEPTH	WIDTH	DEPTH		WIDTH	DEPTH	HEIGHT	PIT	O.H.
IN KG.		A	B	C	D	E	F	G	H		
4	272	1900	1300	1100	700	700	2900	3300	2500	1600	4800
6	408	1900	1700	1100	1000	700	2900	3700	2500	1600	4800
8	544	1900	1900	1300	1100	800	2900	3900	2500	1600	4800
10	680	1900	2100	1300	1350	800	2900	4100	2500	1600	4800
13	884	2500	1900	2000	1100	900	3500	3900	2500	1600	4800
16	1088	2500	2100	2000	1300	900	3500	4100	2500	1600	4800
20	1360	2500	2400	2000	1500	2000	3500	4400	2500	1600	4800

All Dimension are in mm. • This is General Data, it may be changed without notice. • All hoist way walls should be minimum 230 mm brick or 150 mm R. C. C.

MRL Type Passenger Elevator



It saves 25% of total elevator equipment area. It reduces 40% of space occupation.

FRANKSON GROUP
Elevator & Escalator

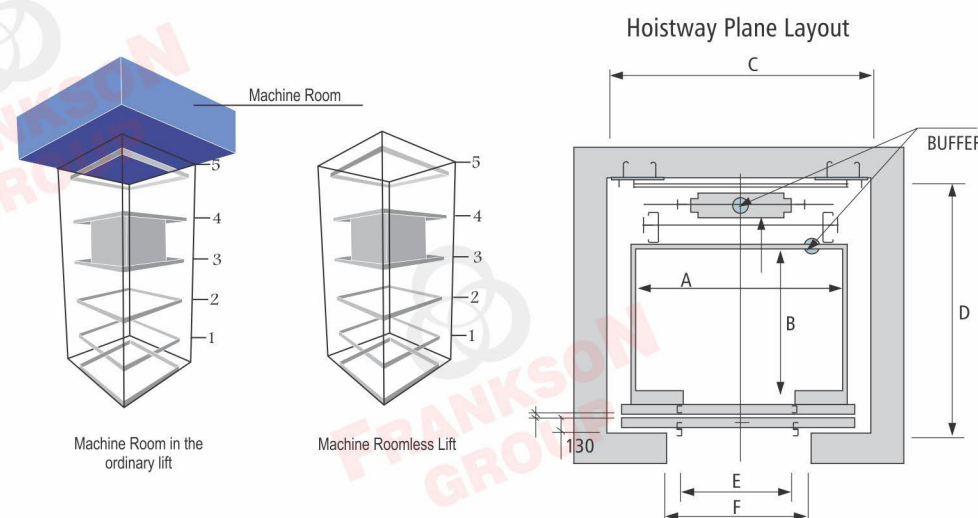
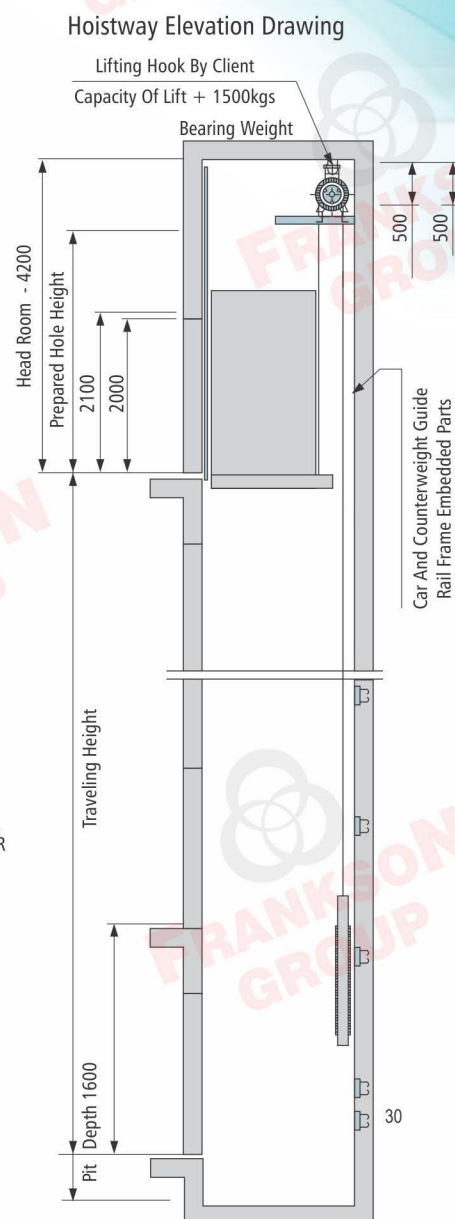

MRL ELEVATOR

Capacity		Car Inside		Lift Well		Clear Entrance		Clear Opening At Landing	
Person	Kgs	A	B	C	D	E	F	F	
							Auto Door	Manual Telescopic	
6	408	1200	900	1800	1400	700	780 / 2100	1450 / 2350	
8	544	1300	1100	1900	1600	800	880 / 2100	1600 / 2350	
10	680	1300	1300	1900	1800	800	880 / 2100	1600 / 2350	
13	884	1600	1400	2200	1900	900	980 / 2100	1700 / 2350	

www.franksonelevator.com

Hydraulic Type Passenger Elevator



Rope Type Single Cylinder

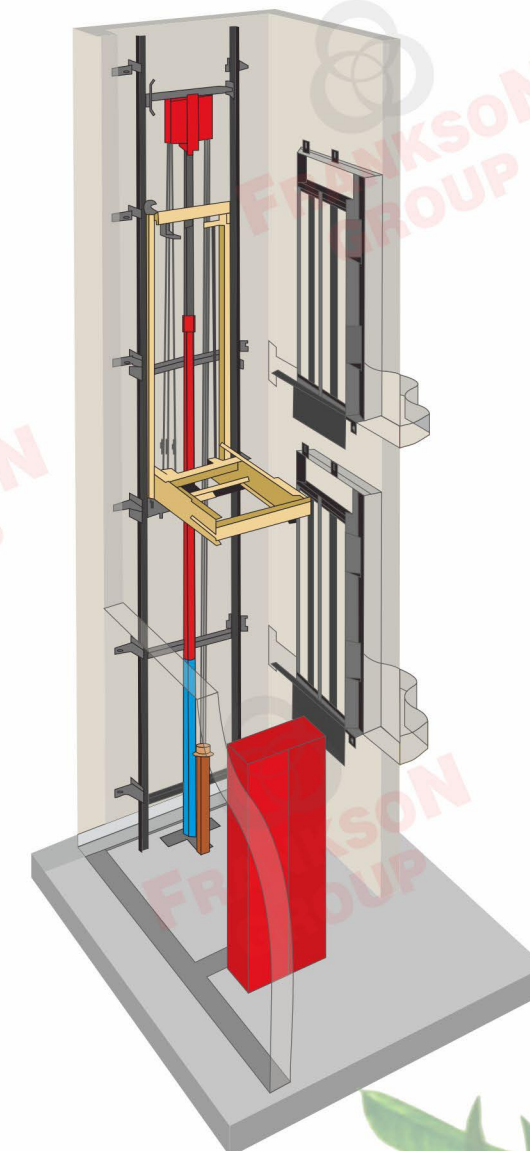
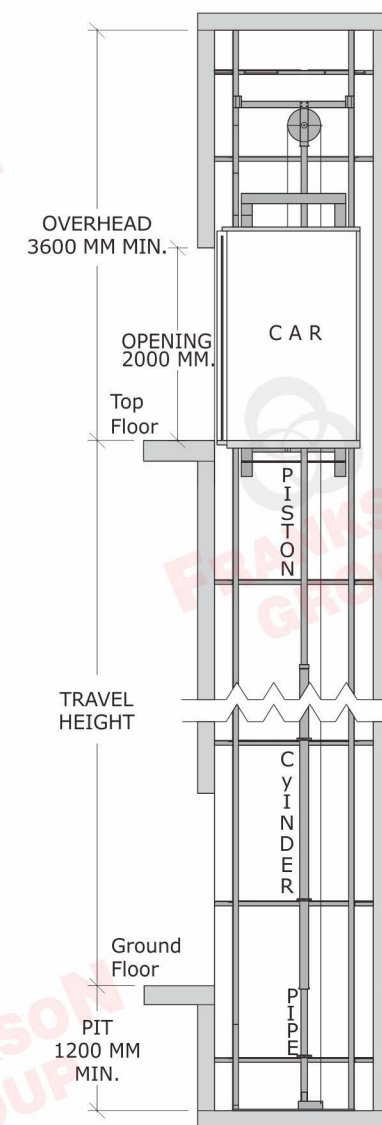
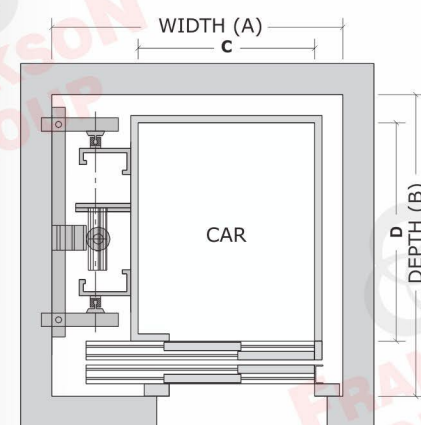

FRANKSON GROUP
Elevator & Escalator

TELESCOPIC OPENING AUTOMATIC DOOR LIFT

Persons	Capacity Kgs.	Shaft-W (A)	Shaft-D (B)	Car-W (C)	Car-D (D)
3	225	1300	1300	750	900
4	300	1350	1450	800	1050
5	375	1500	1500	950	1100
6	450	1600	1550	1050	1150
8	600	1600	1800	1300	1100
10	750	1700	1950	1130	1550
12	900	1800	2050	1230	1650
15	1125	1950	2400	1230	2000
20	1500	2100	2800	1350	2400

Pit : 1200 mm | Ov erhead : 3600 mm Maximum Travel : 15 Meter

Automatic Doors



S.S. Center Opening Autodoor



Center Opening Auto Door
(Big Vision)



Center Opening Auto Door
(Small Vision)



Center Opening Auto Door
(Four Panel)

Decorative Doors

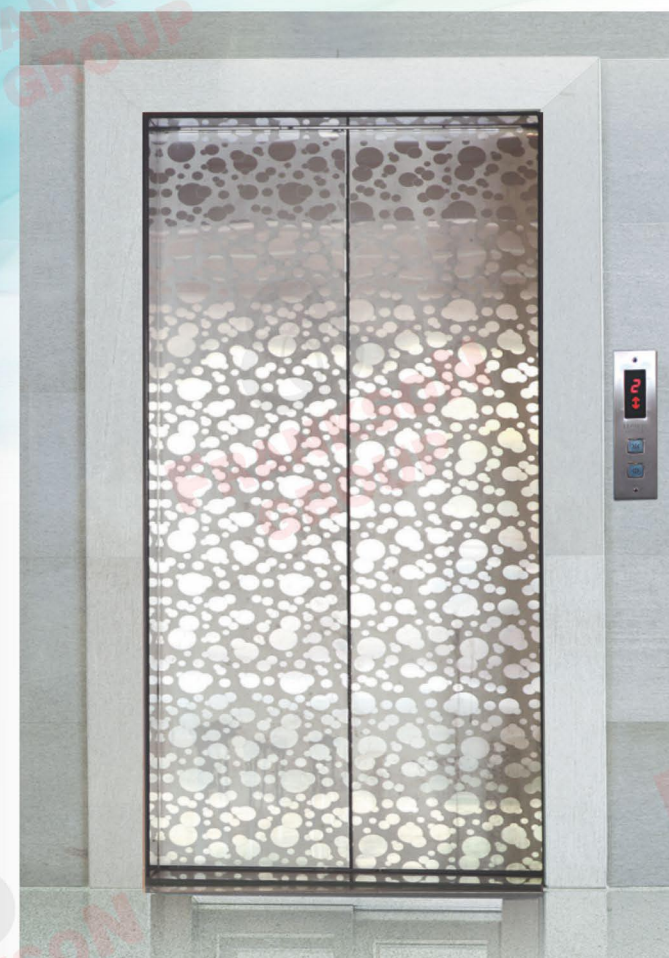

Center Opening Autodoor
(Designer Finish)



Golder Decorative Autodoor



Golden Mirror Etching
Center Opening Door



Golden Mirror Etching
Center Opening Door

Cabins Design



**FGLEC
1019**

- Ceiling** : Mirror stainless steel,
Acrylic transparent plate
Car wall : Mirror stainless steel
+ mirror etching stainless steel
Floor : PVC



**FGLEC
1021**

- Ceiling** : Titanium gold mirror, Titanium gold
etched mirror, European style dome lamp
Car Wall : Etched titanium gold mirror, Marble,
Titanium gold mirror
Handrail : None
Floor : PVC



**FGLEC
1020**

- Ceiling** : Hairline stainless steel,
Acrylic transparent plate
Car wall : Hairline stainless steel
Floor : PVC



**FGLEC
1022**

- Ceiling** : Titanium gold mirror frame, Acrylic light
decoration, Down lamp
Car Wall : Titanium gold stainless steel, Titanium gold
stainless steel mirror
Handrail : Titanium gold mono-tube round handrail
Floor : PVC

S.S. Cabins



**FGLEC
1023**

- Ceiling** : Stainless steel hairline frame,
Central LED light
Car wall : Stainless steel hairline,
Mirror, Etched
Handrail : Stainless steel round tube
Floor : PVC floor



**FGLEC
1025**

- Ceiling** : Hairline stainless steel
Car wall : Hairline stainless steel
Car door : Hairline stainless steel
COP : Hairline stainless steel
Floor : PVC floor



**FGLEC
1024**

- Ceiling** : On both sides of the mirror stainless steel
floor with LEDs light lighting design
Operating panel : Integrated operating panel
Car wall : Hairline stainless steel
Car door : Hairline stainless steel
Floor : Standard PVC



**FGLEC
1026**

- Ceiling** : LX-05
Wall : Art glass, STS mirror, High glossy graphic,
Al sliver molding (10mm)
Door : Highly glossy graphic
COP : DS-M-TK77
Handrail : HRR-01E / Polishing
Floor : Marble (by local supplier)

Manual Door Elevator



Frankson Group Manual door elevators are durable by design and accurate by technology. We have a wide range of these elevators which are most reliable and designed to suit every construction requirement and provide best vertical transportation solutions, with trouble free performance and low maintenance cost. These elevators are a perfect blend of Cost friendly and robust performance elevator applications. They have an excellent record of customer satisfaction.



- ▶ The passenger elevators detailed here are designed to handle promptly and efficiently the vertical transportation requirements of any type of building considering any traffic condition.
- ▶ Delivers maximum lifting power with a minimum of effort.
- ▶ A superior combination of flexibility and performance.
- ▶ It gives benefits of jerk-less traveling, economically low power consumption and excellent design.



www.franksonlevator.com

Manual Door Elevator

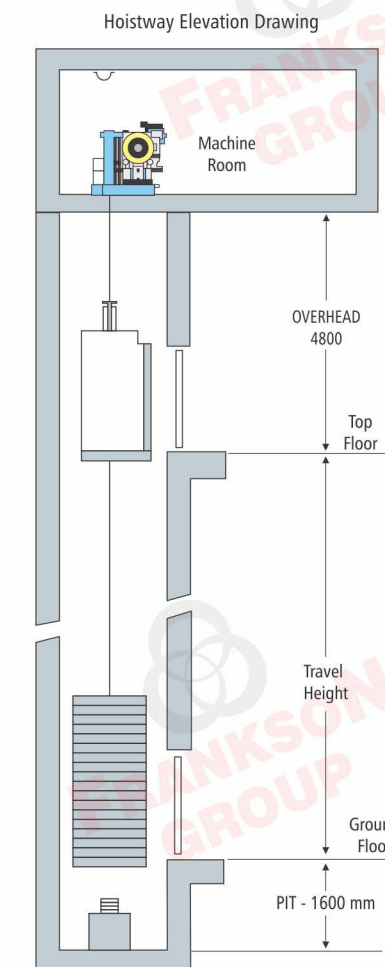
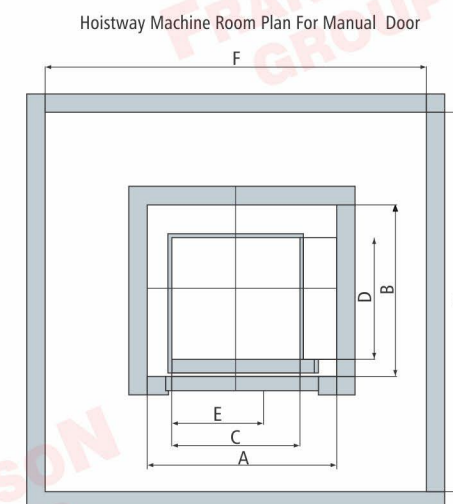
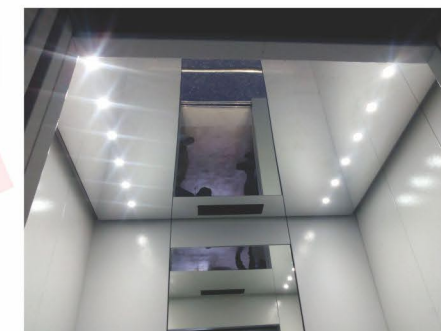

Hoist Way Machine Room Size Passenger Elevator with Manually Operated Doors

LOAD		LIFT WELL		CAR INSIDE		ENTRANCE	MACHINE ROOM			SPEED UP TO 1 m/s.	
PERSON	WEIGHT	WIDTH	DEPTH	WIDTH	DEPTH		WIDTH	DEPTH	HEIGHT	PIT	O.H.
IN KG.		A	B	C	D			G	H		
4	272	1300	1300	1100	700	700	2600	3200	2500	1600	4800
5	340	1400	1300	1100	850	700	2600	3350	2500	1600	4800
6	408	1500	1500	1100	1000	700	2600	3500	2500	1600	4800
8	544	1800	1800	1350	1300	800	2850	3800	2500	1600	4800
10	680	2300	2100	2000	1300	800	3500	3800	2500	1600	4800
13	884	2600	2300	2000	1300	900	3500	3800	2500	1600	4800
15	1020	2700	2400	2000	1300	900	3500	3800	2500	1600	4800

• All Dimension are in mm. • This is General Data, it may be changed without notice. • All hoist way walls should be minimum 230 mm brick or 150 mm R. C. C.

Manual Doors



Manual Full Glass Door



Imperforated Door

Manual Doors



Collapsible Door



Manual Sliding Glass Door



M.S. Two Fold Telescopic Door



S.S. Two Fold Telescopic Door



M.S. Swing Door



Wooden Center Opening
4 Panel Door

Cabins

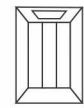

FGLEC
1027

Ceiling : Powder Paint + LED Light
Car wall : M.S. Powder Painted
Floor : Granite Finish
Ventilation : Square Fan

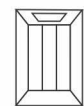

FGLEC
1029

Ceiling : Stainless Steel + LED Light
Car wall : M.S. Powder Coted & S.S. Combination
Car wall Center : Half Glass
Floor : Rubber Sheet
Ventilation : Square Fan

FRANKSON[®]
GROUP
Elevator & Escalator



FGLEC
1028

Ceiling : Powder Paint + LED Light
Car wall : Tow Color M.S. Powder Painted
Floor : Rubber Sheet
Ventilation : Round Fan

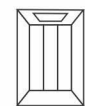

FGLEC
1030

Ceiling : Acrylic + LED Light
Car wall : Tow Color M.S. Powder Painted
Floor : Rubber Sheet
Ventilation : Blower Fan

Cabins



FGLEC
1031

Ceiling : Powder Coted + LED Light
Car wall : Tow Color M.S. Powder Painted
Floor : Granite Sheet
Ventilation : Square Fan



FGLEC
1033

Ceiling : Pattern Designer LED Light
Car wall : Tow Color M.S. Powder Painted
Floor : Granite Sheet
Handrail : Stainless Steel Round
Ventilation : Blower Fan

FRANKSON[®]
GROUP
Elevator & Escalator



FGLEC
1032

Ceiling : Decorative LED Light
Car wall : M.S. Painted & Wooden Combination
Floor : Wooden Sheet
Handrail : Stainless Steel Round
Ventilation : Blower Fan

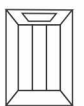
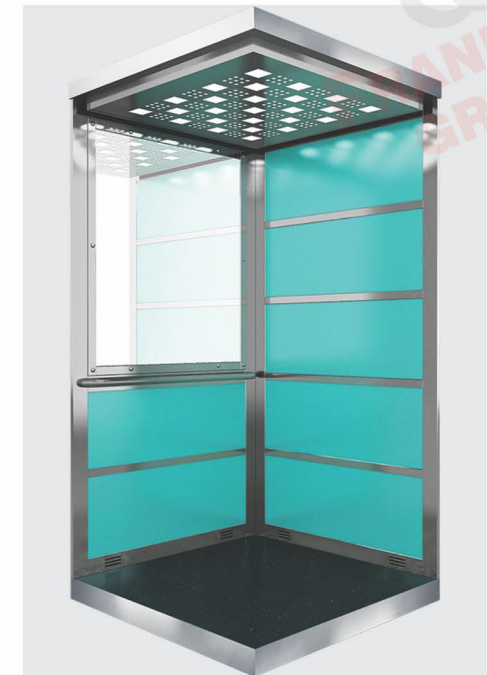

FGLEC
1034

Ceiling : Acrylic Decorative LED Light
Car wall : M.S. Painted & Half Glass + Strips
Floor : Grenite
Ventilation : Blower Fan

COP & LOP



- Identify the hand gesture to register the hall call through human body infrared technology.
- High sensitivity, can identify human gloved hands.
- Ease to use, hand swing upwards or downwards to trigger the hall call.

Elegant design.
Easy to operate.
An invitation to
passenger control.

FRANKSON[®] GROUP Elevator & Escalator

Our control panels, for both car and landing, use technologically advanced products of modern design and functionality.

The integration of buttons, symbols, communication, alarms, security and key functions ensures the passengers is in full control. Total Elevators range of push button panels, both in the car and on the landing, are of the highest quality and can be mounted to suit any architectural requirements.



KCG 351



KXG351



BC 163B



BX 165



Touch COP



Touch LOP



Glass COP



Glass LOP



KCG 311



KXG 311

Machines

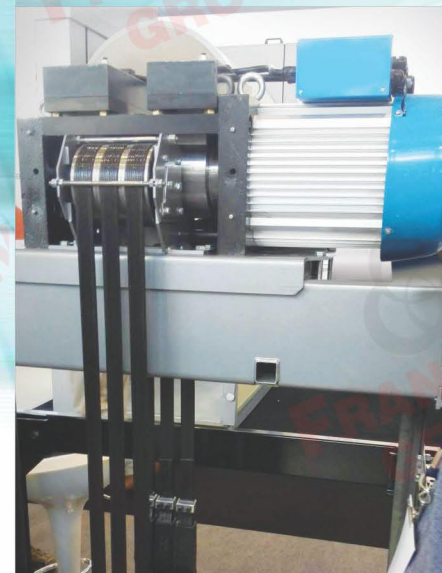

Belt Drive Machine

Using high quality gear drive machines and V3F Drives, these lift performance is of the highest standard

Geared Machine



Heavy Duty Traction Machine

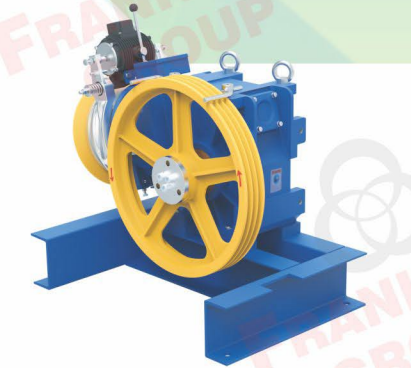

High Speed Traction M/c.

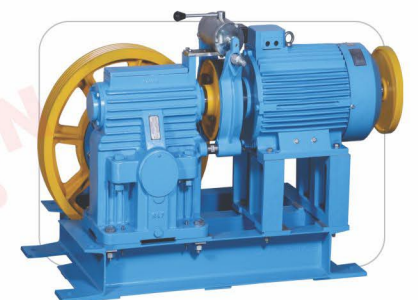

Upper Traction M/c.

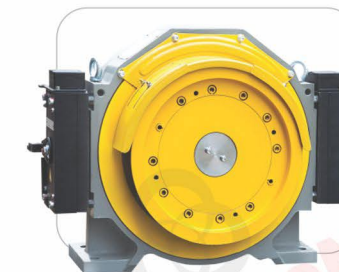

Gearless Machine



Home Lift Single Phase
Gearless Machine

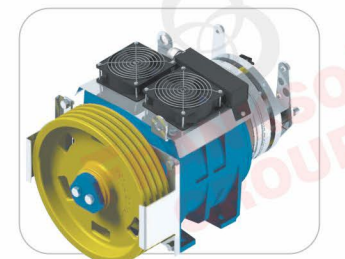

Gearless Machine

Gearless Machine

High Precision Positioning Control System

V3F Drive



- www.franksonlevator.com
- www.frankson.in
- www.franksongroup.com



CE-4046 Certification



ISO 45001 : 2018 Certified Company



ACCREDITED
Management Systems
Certification Body
MSCD-119



ISO 9001 : 2015 Certified Company



ISO 14001 : 2015 Certified Company



**FRANKSON[®]
GROUP**

Elevator & Escalator

All Over India & International Branch

Kolkata Branch :

Chinar Park Rajarhat,
(Opposite to Teghoria Loknath Mandir)
K.R. Plaza, Ground Floor, Kolkata - 700157.

Phone : +91 33 2516 0456, 2516 0457,
2986 0651

Hotline : 90075 56123, 97351 20009,
97357 84005

Factory Address:

Malayapur, Raghunathpur Baduria 24 PGS
(North Wst Bengal) Pin - 743401
Phone : 03217 237061 / 9476483337

E-mail : franksonlevator@gmail.com
franksonlift@gmail.com
sales@frankson.in
service@frankson.in
complain@frankson.in



+ 91 9007556123



+ 91 9735784005